

DS-Series LED-backlit Display 55"

One Set Display,
Twice the Impact



Featuring Full HD resolution and high brightness, the DS-Series is capable of delivering crisp images in diverse indoor environments. Dual HDMI connections make it easy to integrate IPCs or media players to display unique content on each screen. With a metal housing and flexible orientations, the DS-Series is ideal for retail locations, point of sale signage, as well as advertising in public environments.





Slim Metal Housing

With a 23.4 mm amazingly slim profile, the DS-Series is shielded by a thin but highly-durable metal housing that creates a compact profile while ensuring safety and durability in public settings.

Adaptable Orientations

Enabling both portrait and landscape modes, the DS-Series allows you to select the orientation that suits the setting.

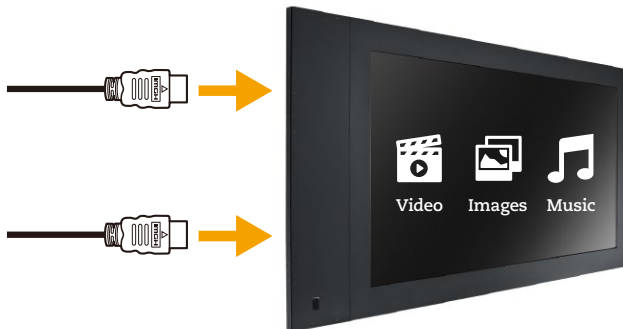

Multiple Media Playback Options

HDMI ports located on both the front and rear of the display allow you to incorporate either media players or IPCs to broadcast the media of your choice.

Features

- Full HD 1920 x 1080 resolution
- 700 nits high brightness panels (front & back) fulfill diverse professional signage applications
- VA Panel technology ensures accurate colours and offers high contrast ratios with wide viewing angles
- Dual-sided LCD signage with independent HDMI inputs
- Durable metal housing
- 23.4mm slim depth design
- Designed and developed for continuous 24/7 operation



Specifications

DS-55

Panel	Panel Type	LED-Backlit TFT LCD (VA Technology)
	Panel Size	54.6"
	Max. Resolution	FHD 1920 x 1080
	Pixel Pitch	0.630 mm
	Brightness	700 cd/m ²
	Contrast Ratio	4000:1
	Viewing Angle (H/V)	178°/178°
	Display Colour	1.07B
	Response Time	5 ms
	Surface Treatment	Anti-Glare Treatment (Haze 11%), 3H Hard Coating
Frequency (H/V)	H Freq.	30 kHz-92 kHz
	V Freq.	49 Hz-85 Hz
Input	HDMI	1.4 x 2
Power	Power Supply	Internal
	Power Requirements	AC 100-240V, 50/60 Hz
	On Mode	192W (On)
	Stand-by Mode	< 2W
Off Mode	< 1W	
Operating Conditions	Temperature	0°C-40°C (32°F-104°F)
	Humidity	20%-80% (non-condensing)
Storage Conditions	Temperature	-10°C-50°C (14°F-122°F)
	Humidity	20%-80% (non-condensing)
Dimensions	Display (W x H x D)	857.4 x 1515.9 x 23.4 mm (33.8" x 59.7" x 0.9")
	Power Box (W x H x D)	220.0 x 406.0 x 55.0 mm (8.7" x 16.0" x 2.2")
	Packaging (W x H x D)	1618.0 x 970.0 x 249.0 mm (63.7" x 38.2" x 9.8")
Weight	Display	45.5 kg (100.3 lb)
	Power Box	4.0 kg (8.8 lb)
	Packaging	56.5 kg (124.6 lb)
Regulation Approval	Certifications & Compliance	CB, CE, FCC, RoHS, WEEE, REACH, EAC
Accessories	Supplied	Power Cord, Remote Control, Batteries, Power Box

Global Headquarters

Taipei, Taiwan

EMEA Regional Headquarters

Capelle a/d IJssel, The Netherlands

North & South America Regional Headquarters

San Jose, CA, U.S.A.

Asia-Pacific Regional Headquarters

Taipei, Taiwan

Canada Sales Office

Vancouver, B.C., Canada

China Sales Office

Shanghai, China

Czech Republic Sales Office

Brno, Czech Republic

Denmark Sales Office

Støvring, Denmark

Germany Sales Office

Mechernich, Germany

Italy Sales Office

Livorno, Italy

Poland Sales Office

Warsaw, Poland

Spain Sales Office

Barcelona, Spain

Ukraine Sales Office

Lviv, Ukraine

displays.agneovo.com